

Scan the QR code for more product information

Copyright © ICY DOCK International. All Rights Reserved. 650276 VER 1.0

1 Package Contents • Packungsinhalt • Contenu • Contenido del paquete • 包装について • 包装説明 • 包装说明

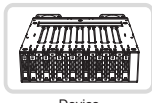

Device

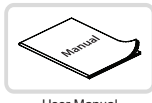

User Manual

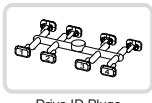

Drive ID Plugs

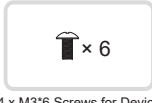

4 x M3*6 Screws for Device (2 x Screws for Spare Parts)

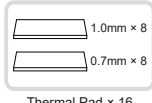

Thermal Pad x 16

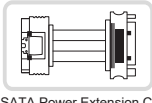

2 x SATA Power Extension Cable

ⓘ Note: Please use the included screws to secure the device

ⓘ Note: Please use the extension cables before connecting to your cable

2 Device Information • Geräteinformationen • Informations dispositif • Información del dispositivo • 本体説明 • 機體説明 • 机体说明

▼ Front View

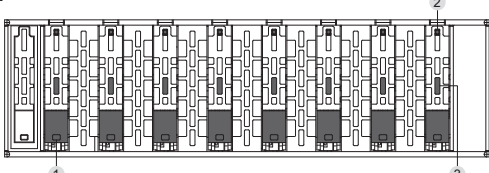

- 1 Drive Tray Ejection Button
- 2 LED Indicator (Power: Solid Green; Drive Access: Flashing Green)
- 3 Slot for Drive ID Plug

▼ Side View

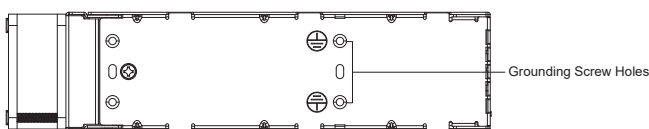

ⓘ Note: When installing the ToughArmor MB873MP-B, only the lower screw holes have to be secured. This device can be installed upside down if desired

▼ Rear View

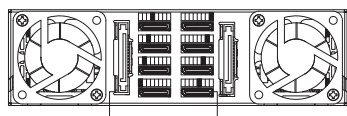

15 Pin SATA Power OcuLink (SFF-8612)

▼ Drive Tray Inner View

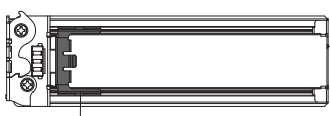

Adjustable M.2 SSD Locker Guide Pin to Align M.2 Connector

3 Installation Guide • Installationsanleitung • Guide d'Installation • Guía de instalación • 製品の組み込み手順について • 操作步驟 • 操作步驟

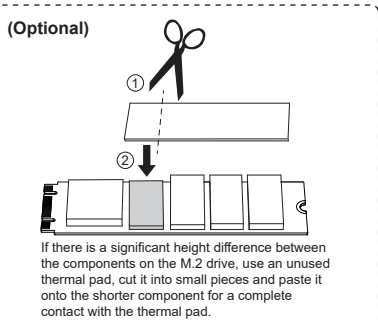
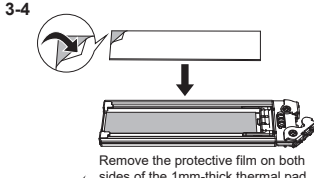
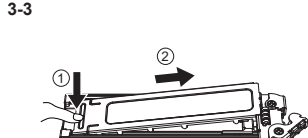
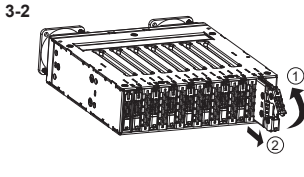
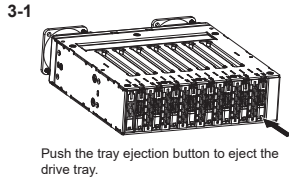

Warning
If using the 1mm thermal pad on the M.2 drive and it prevents M.2 drive from mating with the enclosure's connector correctly, please use the 0.7mm thermal pad instead.

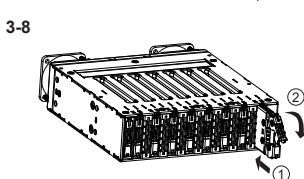
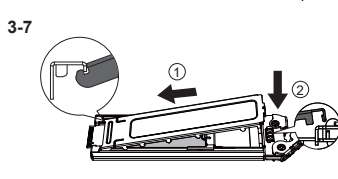
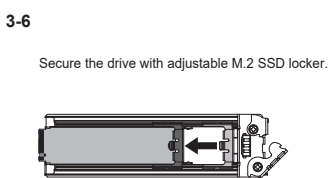
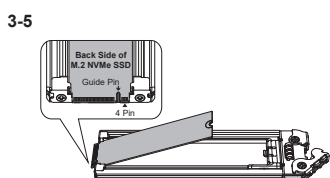

4 Device Installation • Installation eines Gerätes • Installation du dispositif • Instalación del dispositivo de • デバイス取付手順 • 装置安裝步驟 • 裝置安裝步驟

*Cables are not included

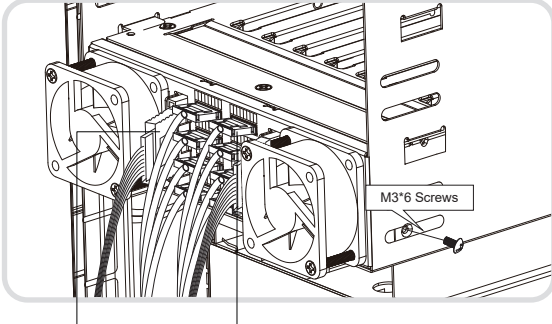

15 Pin Power Connector OcuLink Cable

ⓘ Note: If the drive is not detected by the system, go to "device manager", right click on "disk drives" and then select "scan for hardware changes" to perform manual hardware refresh



For the warranty information, please visit www.icydock.com/warranty.php